



Owner's Manual



FA2000 Handheld Sealer
For use with FM2000/FM2100 Models
FA2000-000

Your new Handheld Sealer can be used with all FM2000/FM2100 FoodSaver® Vacuum Sealer models

Works with FoodSaver® Vacuum Zipper Bags, Containers, Canisters, and ALL other FoodSaver® accessories such as Wine Stoppers, Jar Sealers and Marinator without requiring additional adaptors, governors, etc.

Handheld Sealer with Clip

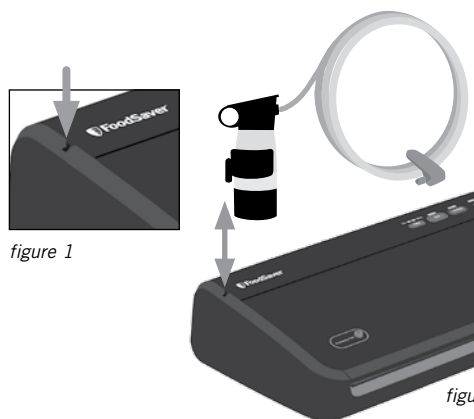
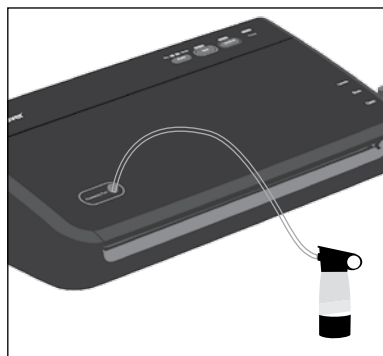
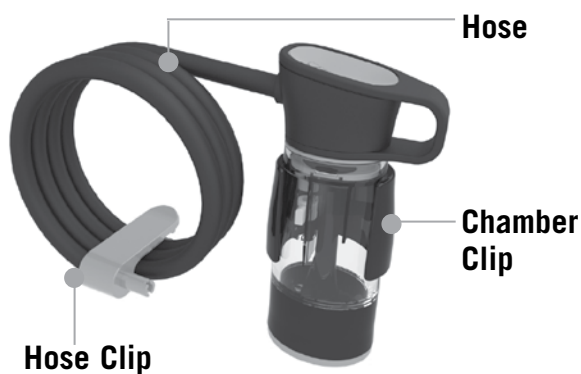

Attaching the Handheld Sealer

1. Remove the plastic plug on the left side of the appliance by pressing down and prying up with a butter knife or similar dull object.
2. Push the Chamber Clip into the hole until it clicks into place.

How to...

Use Handheld Sealer with Vacuum Zipper Bags

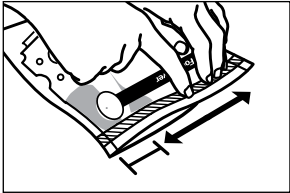

1. Place food into Zipper Bag. Make sure not to put any food under valve. Press zipper closed with finger while bag is lying down on a flat surface.

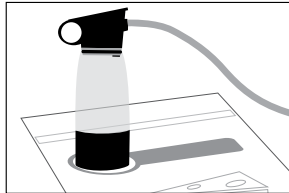

2. Pull Handheld Sealer from appliance. Place end over the white valve on bag.

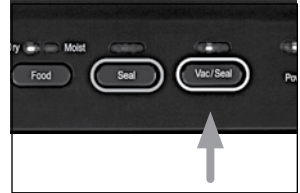

3. Push Vac/Seal button to begin vacuum process. Motor will run until vacuum process is complete.

How to...

Vacuum Seal with FoodSaver® Accessories

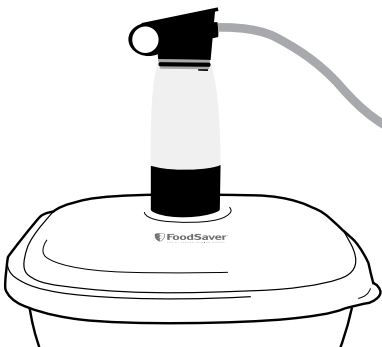

Containers

1. Prepare container according to FoodSaver® Accessory Guidelines, which are included with accessory purchases.
2. Pull Handheld Sealer from appliance. Place end over gray valve on container.
3. Push Vac/Seal Button to begin vacuum process. Motor will run until vacuum process is complete.

How to...

Vacuum Seal with FoodSaver® Accessories

Canisters

1. Prepare canister according to FoodSaver® Accessory Guidelines, which are included with accessory purchases.
2. Pull Handheld Sealer from appliance and remove clear bottom portion of handheld from top handle (Fig. 1). Insert the end into the port on accessory. Twist tab while inserting to ensure a tight fit.
3. Push Vac/Seal Button to begin vacuum process. Motor will run until vacuum process is complete.
4. When motor turns off, gently twist and remove Handheld Sealer from accessory.

NOTE: If you are using a canister with a large white knob, rotate knob clockwise to the “Closed” position, then gently twist and remove Handheld Sealer from accessory.

5. To test vacuum, simply tug on accessory lid. It should not move.

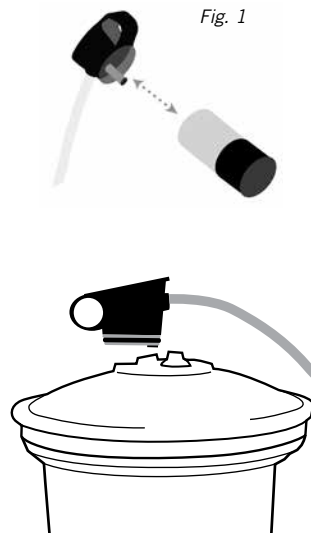

Care & Cleaning



Empty Reservoir after each use.
Wash in warm soapy water.
Air dry before replacing.

To Remove Reservoir from handheld sealer, holding top portion (black upper piece) firmly, pull lower reservoir down and off.

